



An ISO 9001:2015 Certified Company

# GLOBE MACHMOVERS

THE MOVING MUSCLE YOU NEED



## Services:

- \* Customized Manufacturer & Exporter of all kind of Material Handling Equipment
- \* AMC and Service Provider For all type of Material Handling Equipment
- \* Spare Parts of Material Handling Equipment





IS PROUD TO PRESENT

# GLOBE MACHMOVERS

AS ONE OF THE

## TOP 10 MATERIAL HANDLING SOLUTIONS 2023

*in acknowledgement of its unwavering focus and dedication  
to achieve excellence in quality and delivery in this field.*

*Sudhakar Singh*

Sudhakar Singh  
Managing Editor  
Industry Outlook



**GM-101**

### Single Mast Hydraulic Goods Lift

Cap : 500Kg to 1.5 Ton

Lifting Ht (mm): As Per Requirements



**GM-102**

### Double Mast Hydraulic Goods Lift

Cap : 500Kg to 5 Ton

Lifting Ht (mm): As Per Requirements



**GM-103**

### Electric Wire Rope Hoist Goods Lift

Cap : 500Kg to 5 Ton

Lifting Ht (mm): As Per Requirements

**GM-104**

### Traction Counter weight Goods Lift

Cap : 500Kg to 5 Ton

Lifting Ht (mm): As Per Requirements





**GM-105**

### Pit Mounted Scissor Lift

Cap : 500Kg to 20 Ton  
Lifting Ht (mm): As Per Requirements



**GM-106**

### Scissor Lift Table

Cap : 300 Kg to 1 Ton  
Lifting Ht (mm) : 800mm to 1800mm



**GM-107**

### Mobile Scissor Lift

Cap : 300 Kg to 3 Ton  
Lifting Ht (mm) : 600mm to 6000mm

**GM-108**

### Car Lift

Cap : 1000 Kg to 5 Ton  
Lifting Ht (mm) : 800mm to 8000mm

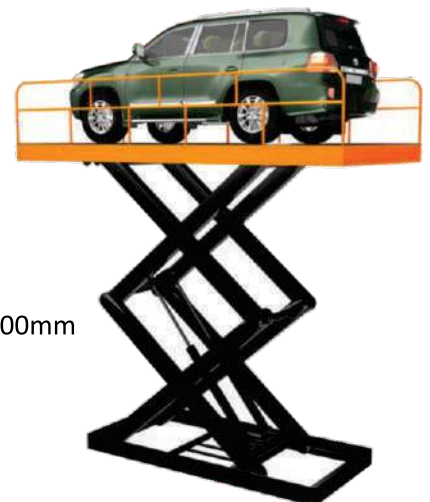



**GM-109**

### Manual Stacker

Cap : 500Kg to 1.5 Ton  
Lifting Ht:- 800mm to 3000mm



**GM-110**

### Semi Automatic Stacker (Battery Operated / Electric )

Cap : 500Kg to 1.5 Ton  
Lifting Ht:- 800mm to 4000mm



**GM-111**

### Wide Leg Straddle Stacker (Manual / Semi Automatic Stacker)

Cap : 500Kg to 1.5 Ton  
Lifting Ht:- 1000mm to 4500mm



**GM-112**

### Rill Stacker (Manual / Semi Automatic Stacker)

Cap : 500Kg to 1.5 Ton  
Lifting Ht:- 1000mm to 2500mm



**GM-113**

### Roller Platform Stacker (Manual / Semi Automatic Stacker)

Cap : 500Kg to 1.5 Ton  
Lifting Ht:- 1000mm to 3000mm



**GM-114**

### Semi Electric Flame Proof Stacker

Cap : 500Kg to 1.5 Ton  
Lifting Ht:- 1000mm to 4000mm



**GM-115**

### Walkie Stacker

Cap : 500Kg to 1.5 Ton  
Lifting Ht:- 2000mm to 4500mm



**GM-116**

### Fully Electric Stacker

Cap : 500Kg to 1.5 Ton  
Lifting Ht:- 3000mm to 6000mm



**GM-117**

### Drum Trolley (MS/SS)

MOC: MS / SS  
Cap : 350Kg

**GM-118**

### Semi Automatic Lifter Tilter (Battery Operated / Electric)

Cap : 400Kg  
Lifting Ht:- 800mm to 4000mm



**GM-119**

### Drum Drainer (Handler)

Cap : 350Kg



**GM-120**

### Drum Carrier

Cap: 350Kg  
Lifting Ht: 200mm



**GM-121**

### Drum Racking

Customized



**GM-122**

### Drum Lifter

(Manual/ Semi Automatic)

Cap: 350Kg  
Lifting Ht : 1400mm to 2500mm



**GM-123**

### Manual Drum Lifter Tilter

Cap: 350Kg  
Lifting Ht : 1400mm to 2500mm



**GM-124**

### Flame Proof Semi Electric Lifter Tilter

Cap: 350Kg  
Lifting Ht : 1400mm to 4500mm



**GM-125**

**Hand Pallet Truck (MS / SS)**

Cap : 2.5 Ton to 5 Ton  
Lifting Ht: 200 mm



**GM-126**

**Beam / Roll Pallet Truck**

Cap : 500Kg to 3 Ton  
Lifting Ht: 200 mm



**GM-127**

**High Lift Pallet Truck (MS / SS)**

Cap : 500Kg to 1 Ton  
Lifting Ht: upto 1000mm



**GM-128**

**Rough Terrain Pallet Truck**

Cap: 500Kg to 2.5 Ton  
Lifting Ht: 200 mm



**GM-129**

**Battery Operated Pallet Truck**

Cap: 1.0 Ton to 2.5 Ton  
Lifting Ht: 200 mm



**GM-130**

**Weight Scale Pallet Truck**

Cap: 2 Ton  
Lifting Ht: 200 mm



GM-131

Platform Trolley



GM-132

Tray Trolley (2/3/4)



GM-133

Box Trolley



GM-134

Single Gas Cylinder Trolley



GM-135

Double Gas Cylinder Trolley



GM-136

Double Gas Cylinder Trolley



GM-137

Platform Trolley with Turn Table



GM-138

Platform Trolley with Turn Table and Safety Railing



GM-139

MS Mobile Platform



GM-140

Luggage Trolley / Sack Trolley



GM-141

Stairs Climbing Trolley



GM-142

Warehouse Parcel Trolley





**GM-143**

**Manual Mobile Floor Crane**

Cap: 500Kg to 1.5 Ton  
Min Hook Ht 300mm



**GM-144**

**Electric/ Battery Operated Floor Crane**

Cap: 500Kg to 1.5 Ton  
Min Hook Ht 300mm



**GM-145**

**Rotating Counter Weight Floor Crane**

Cap: 500Kg to 2 Ton  
Min Hook Ht 300mm



**GM-146**

**Chain Pulley**

Cap: 500Kg to 10 Ton



**GM-147**

**Electric Wire Rope Hoist**

Cap: 500Kg to 10 Ton



**GM-148**

**Single Girder EOT Crane**

Cap: 1 Ton to 10 Ton



**GM-149**

**Double Girder EOT Crane**

Cap: 6 Ton to 25 Ton



**GM-150**

**Portable Gantry**

Cap: 500Kg to 3 Ton



**GM-151**

**Jib Crane**

Cap: 500Kg to 2 Ton



GM-152

Roller Conveyor



GM-153

Belt Conveyor



GM-154

Flexibel Conveyor belt



GM-155

3 Wheel Industrial Electric Tow Truck

Cap : 500Kg to 1 Ton



GM-156

4 Wheel Industrial Electric Tow Truck

Cap : 500 Kg to 1.5 Ton



GM-157

Electric Tow Truck with Towing Trolley

Cap : 1.0 Ton to 2.5 Ton



GM-158

Nylon Wheel/ Roller



GM-159

PU Wheel / Roller



GM-160

UHMW I Section Wheel



GM-161

UHMW Solid Block Wheel



GM-162

Virgin UHMW Wheel



GM-163

Solid Rubber Wheel



GM-164

Fixed Cater



GM-165

Swivel Caster



GM-166

Swivel Caster with Locking



GM-167

Industrial Storage Racking System

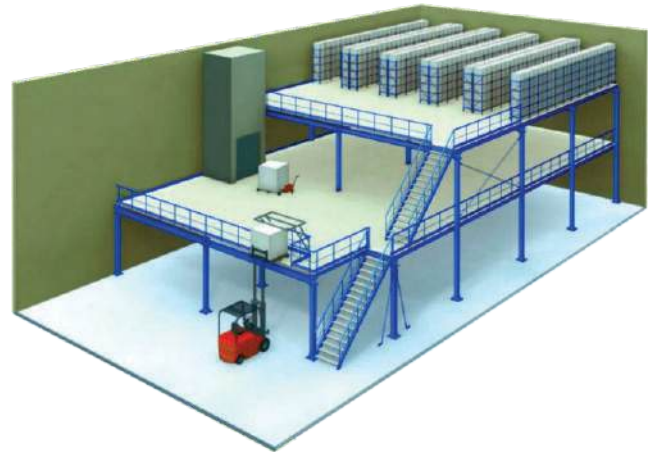

GM-168

Mezzanine Floor (Multi Tier)



GM-169

MS/ SS Storage Pallet



GM-170

Wooden Storage Pallet



GM-171

Plastic Storage Pallet



GM-172

Tool Cabinets



GM-173

Tools Trolley & CNC Transporters



GM-174

Machine Shop Cabinets



GM-175

Roller Shelf / Wall Storage Systems Mobile Storage



GM-176

Workstations



GM-177

Customized Storage Solution

# About Us

## Globe Machmovers - The Moving Muscle You need

The name and the Tagline itself say everything about us. Globe Machmovers is located at Boisar, Palghar, Maharashtra. We are situated at one of the Biggest MIDC of Maharashtra, Well known as Tarapur MIDC. We are the Customized Leading Manufacturer and Service Provider of all kinds of Material Handling Equipment. We Put In Our Best Efforts To Understand your Requirement and fulfill it with a Satisfactory Safe Product.

We are the **Young-blood** with the Vision of Serving the Globe with Made in India Products. Entrepreneurship is a committed organization with a Since endeavor, with the foresight of vision and earnest passion to rise and serve, excel and grow, perform and prove, The company is determined to achieve its rightful place in the global market, It believes, freedom inspires ideas and innovative skills nurture excellence, The company incorporates the latest global innovations.

Driven by the passion to create a world - class entity for itself, the company has an environment that encourages the best potential management which incorporates the best technology and teamwork which stimulates all-round creativity, expansion, and further improvements, The company, and qualified engineers and staff remain alert to the global applications, and market feedbacks.

The ultimate satisfaction of valued clients endorses the company's Commitment to the best techniques and designs backed by value-based performance ethics.

The company out-sources the best materials and best quality 'Business Quality Management' which has triggered to consolidate the effective costs, Today, it offers prime & reliable products at very competitive market prices. The company remains ever - alert to provide and execute the **best after-sales service**.

### Corporate Office :

 Office No. 49 - 50, Bldg. No. B-4, Ostwal Wonder City, Opp. Lokesh Bar & Restaurant, Tata Housing Gate No. 2, Boisar (E), Tal. & Dist. Palghar, Maharashtra, INDIA - 401501

### Contact No. :

 +91 70160 58395 / +91 89990 52574

### Email :

 [sales@globemachmovers.com](mailto:sales@globemachmovers.com)

### Website :

 [www.globemachmovers.com](http://www.globemachmovers.com)

